

# ARKANSAS STATE UNIVERSITY SYNTHETIC TURF REPLACEMENT FOR ARKANSAS STATE UNIVERSITY STADIUM JONESBORO, CRAIGHEAD COUNTY, ARKANSAS

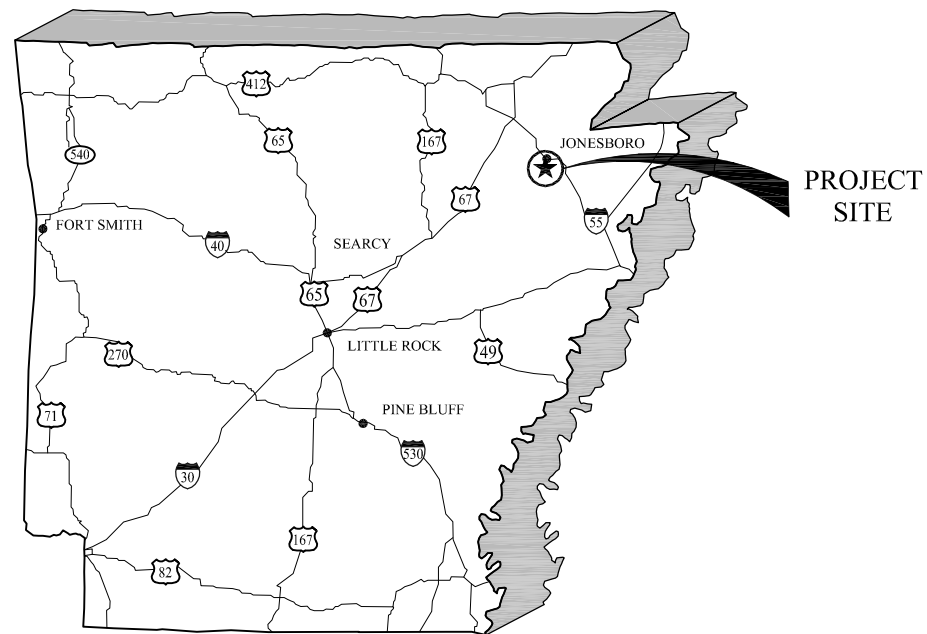

PROJECT LOCATION MAP  
N.T.S.



### SHEET INDEX

- 1 COVER SHEET
- 2 EXISTING SITE PLAN
- 3 DEMOLITION SITE PLAN
- 4 CONSTRUCTION PLAN
- 5 TYPICAL DETAILS
- 6 TYPICAL DETAILS

PROJECT  
SITE



PROJECT LOCATION MAP  
N.T.S.



This document was originally issued and sealed by  
*Jeffery J. Breslee*, # 12057, on  
04/27, 2010.  
This document is not a sealed document.

**S. E. T.**  
SPORTS ENGINEERING TECHNOLOGIES, INC.  
Experts in Outdoor Sports Design & Construction Management  
Licensed Civil Engineers • Planners • Designers  
817-507-8305 Phone | 682-518-9825 FAX

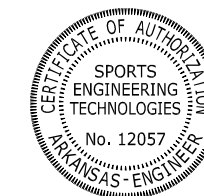

This document was originally issued and sealed by  
*Jeffery J. Breslee*, # 12057, on  
04/27, 2010.  
This document is not a sealed document.

NOTE: STAGING AREA SHALL BE PARKING LOT @ THE SOUTHEAST CORNER OF THE STADIUM FACILITY.

- LEGEND**
- CONTOURS
  - SD--- STORM DRAIN
  - W--- WATER
  - E--- ELECTRICAL
  - FENCELINE
  - IRR--- IRRIGATION : GRAY WATER
  - C--- COMMUNICATION (SOUND SYSTEM)
  - FD--- FRENCH DRAIN SYSTEM
  - DP--- DRAINAGE PIPE
  - ⊠ BENCHMARK
  - ⊞ JUNCTION BOX
  - ⊞ ELECTRIC BOX
  - ⊞ GAS METER
  - ⊞ IRR CNTRL VALVE
  - ⊞ WATER VALVE
  - ⊞ GRATED DRAIN
  - ⊞ SPRK HEAD

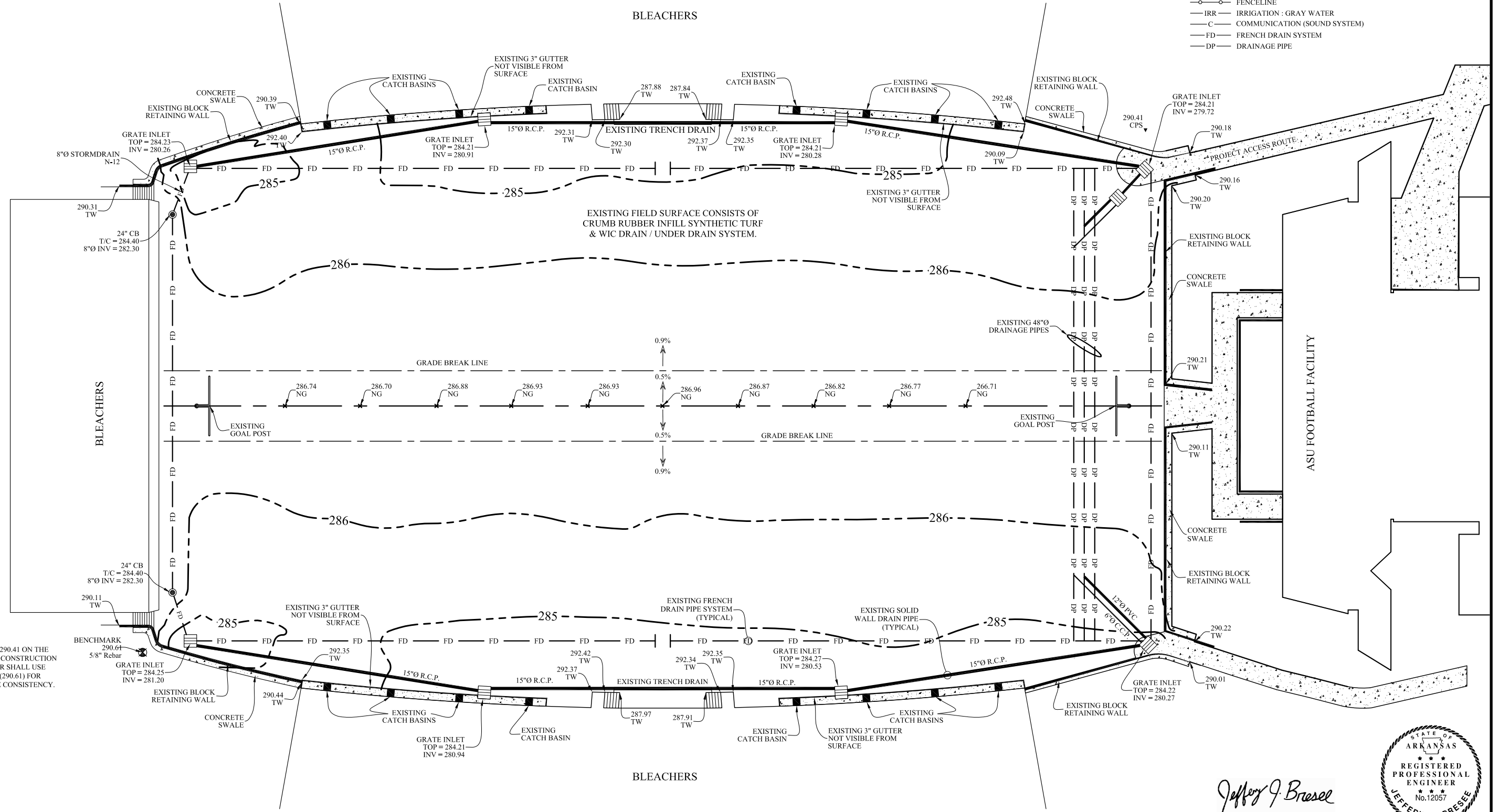

**BENCHMARK NOTE:**  
THIS MARK IS SHOWN AS 290.41 ON THE ORIGINAL TURF PROJECT CONSTRUCTION DRAWINGS. CONTRACTOR SHALL USE THIS ELEVATION DATUM (290.61) FOR THIS PROJECT TO ENSURE CONSISTENCY.

**GENERAL NOTES:**

1. THE CONTRACTOR SHALL BE SOLELY RESPONSIBLE FOR COMPLYING WITH ALL LOCAL, STATE & FEDERAL LAWS & OTHER SAFETY REGULATIONS THAT MAY GOVERN THE WORK OF THIS PROJECT.
2. CONTRACTOR SHALL BE RESPONSIBLE FOR OBTAINING CONSTRUCTION PERMITS AS NEEDED FROM CITY &/OR OTHER LOCAL AUTHORITIES. CONTRACTOR SHALL PAY ALL PERMIT FEES ASSOCIATED WITH OBTAINING PERMITS.
3. CONTRACTOR SHALL BE RESPONSIBLE FOR CLEANING ALL AREAS DISTURBED BY HIS WORK UPON COMPLETION OF WORK TO THEIR ORIGINAL CONDITION OR BETTER.
4. CONTRACTOR SHALL BE RESPONSIBLE FOR THE WELL BEING OF ALL MATERIALS USED IN THIS PROJECT UNTIL THE TIME OF ACCEPTANCE & FINAL PAYMENT.
5. IT SHALL BE THE RESPONSIBILITY OF THE CONTRACTOR TO PERFORM ALL WORK IN ACCORDANCE WITH THE CONTRACT DRAWINGS. NO ADDITIONS, DELETIONS OR MODIFICATIONS TO THE WORK SHALL BE MADE WITHOUT THE WRITTEN APPROVAL OF THE ENGINEER.
6. CONTRACTOR SHALL VERIFY ALL DIMENSIONS ON THE GROUND. ANY DISCREPANCY BETWEEN CONTRACTOR'S MEASUREMENTS & CONTRACT DOCUMENTS SHALL BE BROUGHT TO THE IMMEDIATE ATTENTION OF THE ENGINEER & CONTRACTOR SHALL CEASE WORK UNTIL THE DISCREPANCY IS RESOLVED.
7. CONTRACTOR SHALL HAND DIG WITHIN 5 FEET EITHER SIDE OF UTILITY CROSSINGS UNTIL THE UTILITY IS PHYSICALLY EXPOSED PRIOR TO PERFORMING MECHANICAL TRENCHING OR EXCAVATION.
8. EXISTING BURIED UTILITIES SHOWN IN THE CONTRACT DOCUMENTS WERE ESTABLISHED BY A SEARCH OF RECORDS & BY LOCATING GROUND INFORMATION. THESE UTILITIES ARE SHOWN FOR REFERENCE PURPOSES ONLY & THE LOCATIONS OF SUCH MAY NOT BE EXACT, & OTHER UTILITIES NOT SHOWN MAY EXIST. IT SHALL BE THE RESPONSIBILITY OF THE CONTRACTOR TO INFORM THE PROPER UTILITY AUTHORITIES OF ALL EXCAVATION WORK & TO PHYSICALLY LOCATE & PROTECT ALL UTILITIES DURING THE ENTIRE CONSTRUCTION PROCESS.
9. IT SHALL BE THE CONTRACTOR'S RESPONSIBILITY TO TAKE ALL PRECAUTIONARY MEASURES AS NEEDED TO PROTECT ALL EXISTING FACILITIES, WHICH ARE NOT CALLED FOR IN THE CONTRACT DOCUMENTS TO BE REPAIRED, REPLACED OR OTHERWISE ALTERED, FROM DAMAGE. DAMAGE TO ANY EXISTING FACILITY THAT IS THE FAULT OF THE CONTRACTOR SHALL BE REPAIRED OR THE FACILITY SHALL BE REPLACED AS NEEDED TO RESTORE THE DAMAGED FACILITY TO ITS ORIGINAL CONDITION OR BETTER AT NO ADDITIONAL EXPENSE TO THE OWNER.
10. CONTRACTOR SHALL RESTORE TO ITS ORIGINAL CONDITION OR BETTER, ALL SURFACE MEDIA SPECIFIED ON THE DRAWINGS FOR REPAIR OR ANY DAMAGED AREAS NOT SPECIFIED WHICH ARE DAMAGED BY THE CONTRACTOR'S OWN NEGLIGENCE.

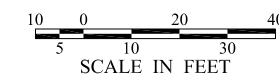

*Jeffery J. Breesee*  
04/27/10



<b>S. E. T.</b> SPORTS ENGINEERING TECHNOLOGIES, INC.		3D04-130 PROJECT NO. MARCH 2010 DATE
ARKANSAS STATE UNIVERSITY SYNTHETIC TURF REPLACEMENT FOR ARKANSAS STATE UNIVERSITY STADIUM		J.J.B. DESIGNED BY C.J.R. DRAWN BY XX CHECKED BY
<b>EXISTING SITE PLAN</b>		<b>2 of 6</b> REV 0

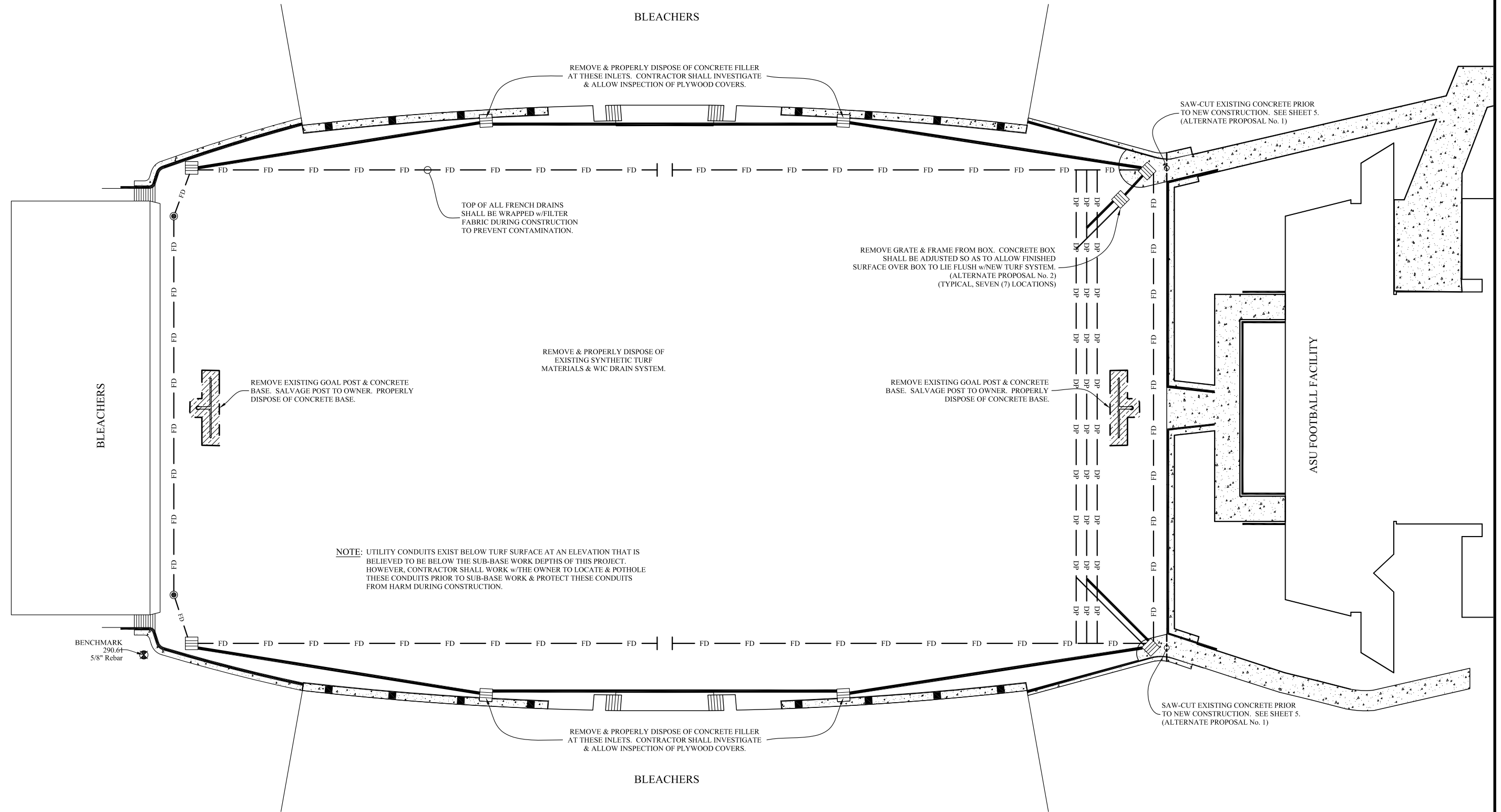

**NOTE:** UTILITY CONDUITS EXIST BELOW TURF SURFACE AT AN ELEVATION THAT IS BELIEVED TO BE BELOW THE SUB-BASE WORK DEPTHS OF THIS PROJECT. HOWEVER, CONTRACTOR SHALL WORK w/THE OWNER TO LOCATE & POT-HOLE THESE CONDUITS PRIOR TO SUB-BASE WORK & PROTECT THESE CONDUITS FROM HARM DURING CONSTRUCTION.

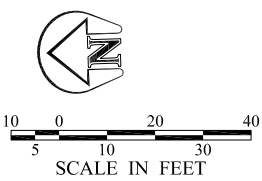

*Jeffery J. Breesel*  
04/27/10



<b>S. E. T.</b> SPORTS ENGINEERING TECHNOLOGIES, INC.		3D04-130 PROJECT NO. MARCH 2010 DATE
ARKANSAS STATE UNIVERSITY SYNTHETIC TURF REPLACEMENT FOR ARKANSAS STATE UNIVERSITY STADIUM		J.J.B. DESIGNED BY C.J.R. DRAWN BY XX CHECKED BY
<b>DEMOLITION SITE PLAN</b>		<b>3 of 6</b> REV 0

FIELD GRADING TEST:  
FIELD GRADES SHALL BE TESTED BY STRING LINE TEST (TOLERANCE SHALL BE ±0.04') PRIOR TO PLACING GEOTEXTILE, DRAIN MAT & TURF SYSTEM. TEST SHALL BE CONDUCTED IN THE PRESENCE OF THE ENGINEER.

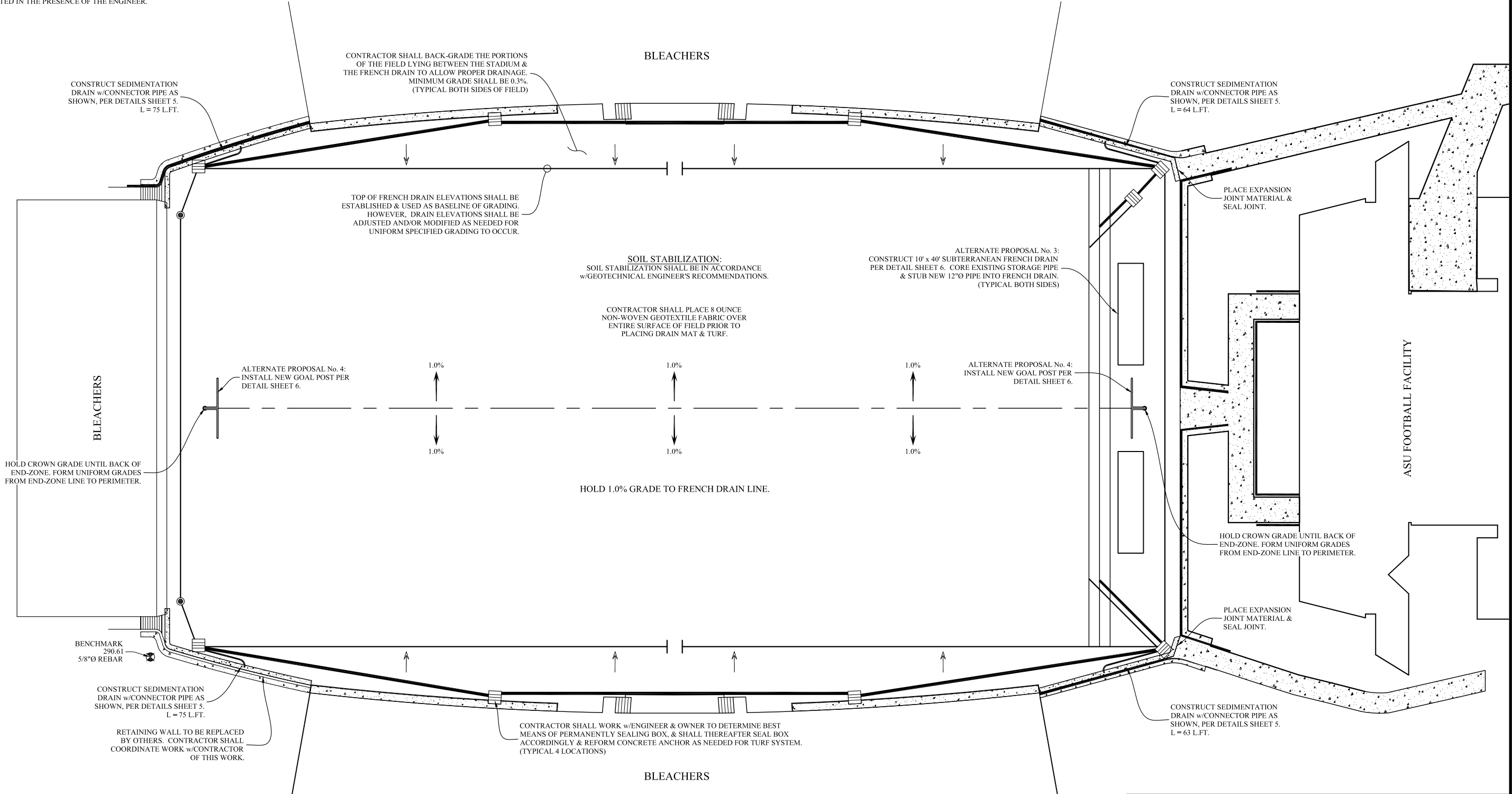

BLEACHERS

ASU FOOTBALL FACILITY

BLEACHERS

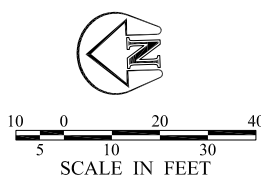

*Jeffery J. Breese*  
04/27/10



<b>S. E. T.</b> SPORTS ENGINEERING TECHNOLOGIES, INC.		3D04-130 PROJECT NO. MARCH 2010 DATE
ARKANSAS STATE UNIVERSITY SYNTHETIC TURF REPLACEMENT FOR ARKANSAS STATE UNIVERSITY STADIUM		J.J.B. DESIGNED BY C.J.R. DRAWN BY XX CHECKED BY
<b>CONSTRUCTION PLAN</b>		<b>4 of 6</b> REV 0

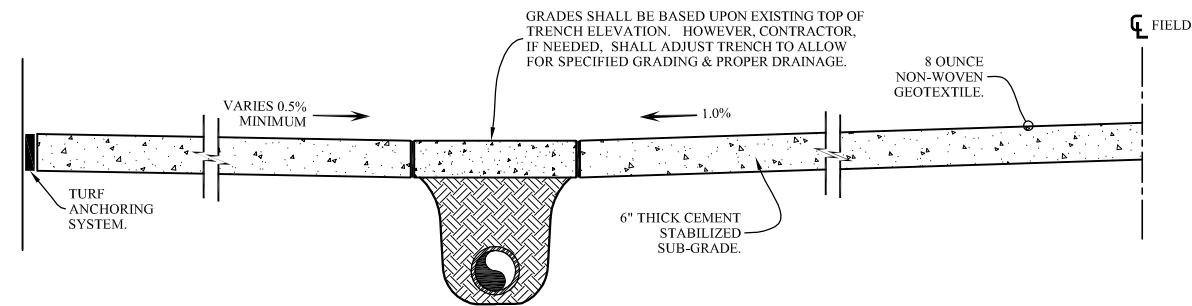

TYPICAL FIELD CROSS SECTION  
N.T.S.

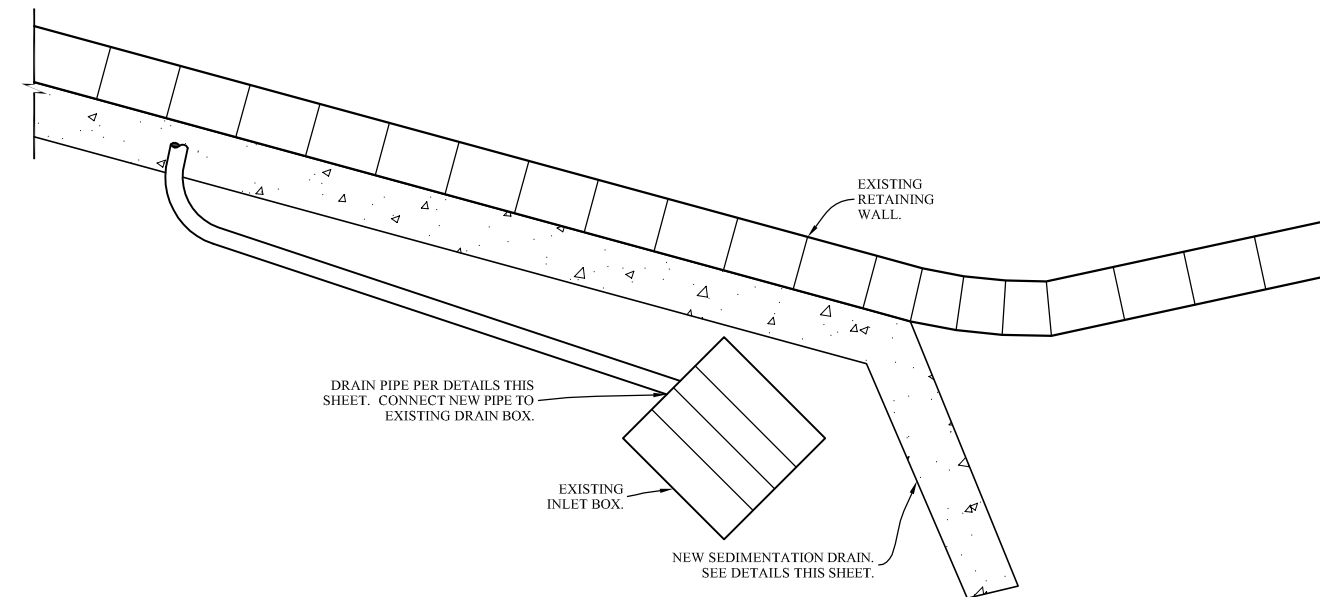

SEDIMENTATION DRAIN DETAIL  
(ALTERNATE PROPOSAL No. 1)  
N.T.S.

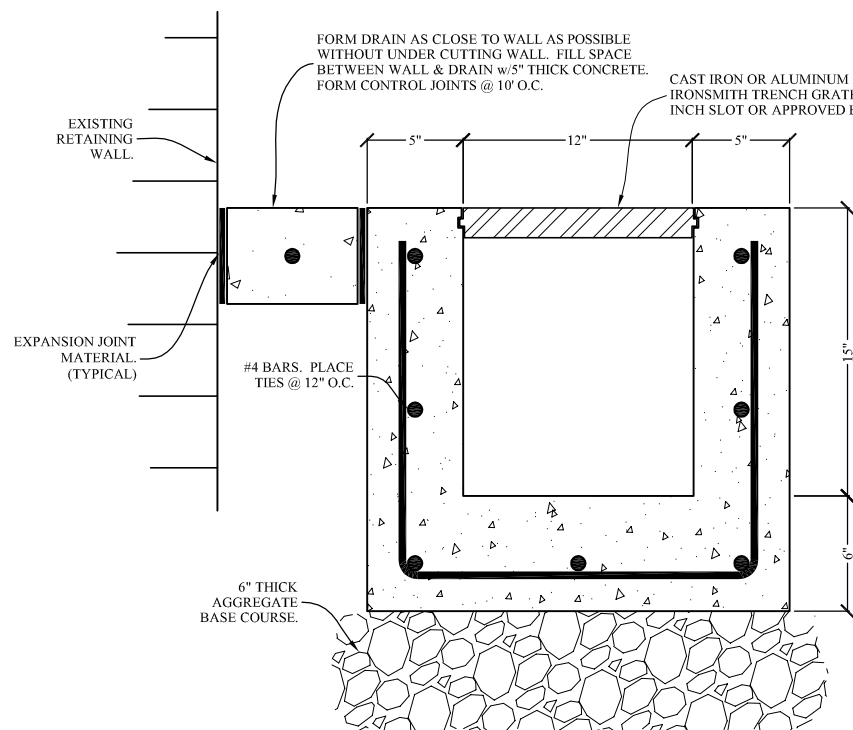

SEDIMENTATION DRAIN SECTION DETAIL  
N.T.S.

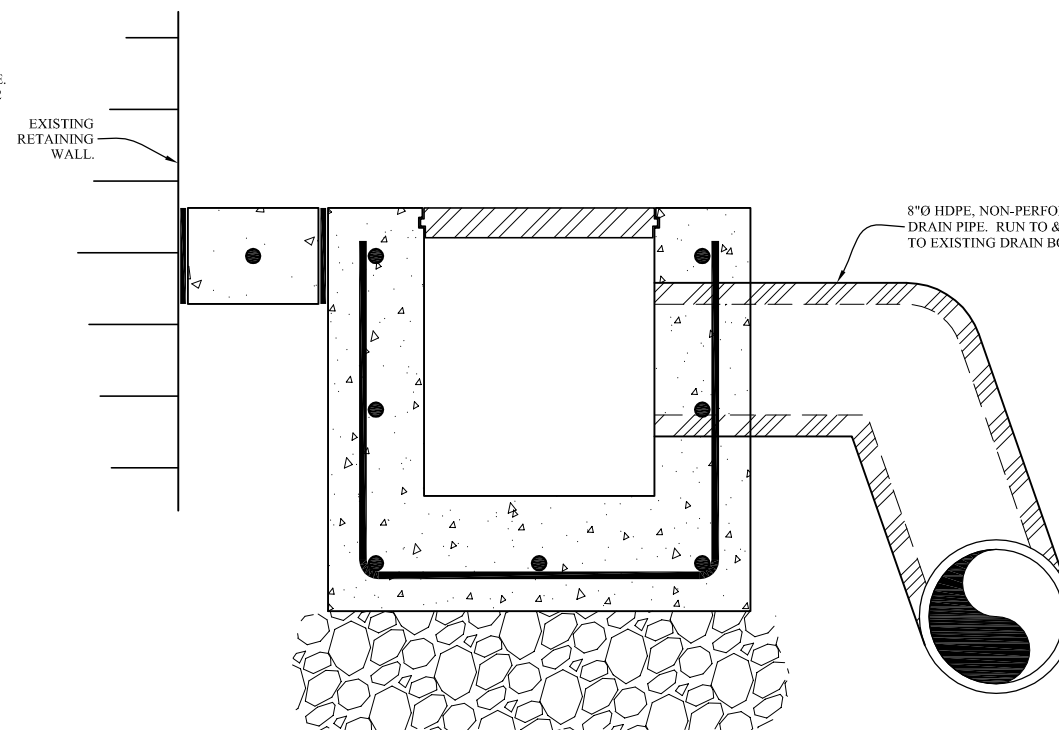

SEDIMENTATION DRAIN OUTLET SECTION DETAIL  
N.T.S.

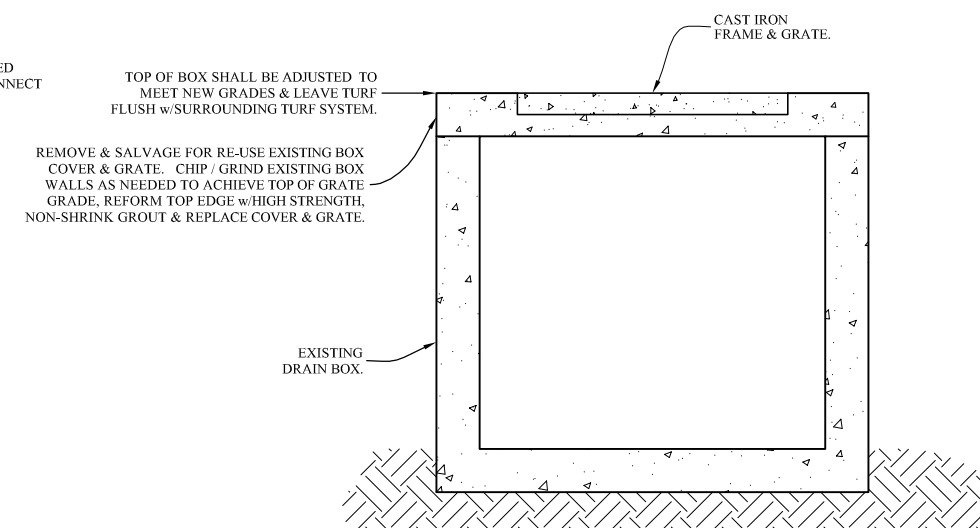

EXISTING DRAIN BOX  
MODIFICATION DETAIL  
(ALTERNATE PROPOSAL No. 2)  
N.T.S.

*Jeffery J. Breese*  
04/27/10



S. E. T. SPORTS ENGINEERING TECHNOLOGIES, INC.	3D04-130 PROJECT NO. MARCH 2010 DATE
ARKANSAS STATE UNIVERSITY SYNTHETIC TURF REPLACEMENT FOR ARKANSAS STATE UNIVERSITY STADIUM	J.J.B. DESIGNED BY C.J.R. DRAWN BY XX CHECKED BY
TYPICAL DETAILS	5 of 6 REV 0

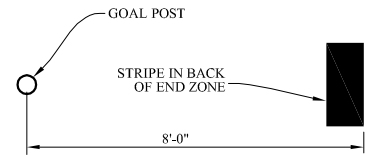

SKETCH "A"  
N.T.S.

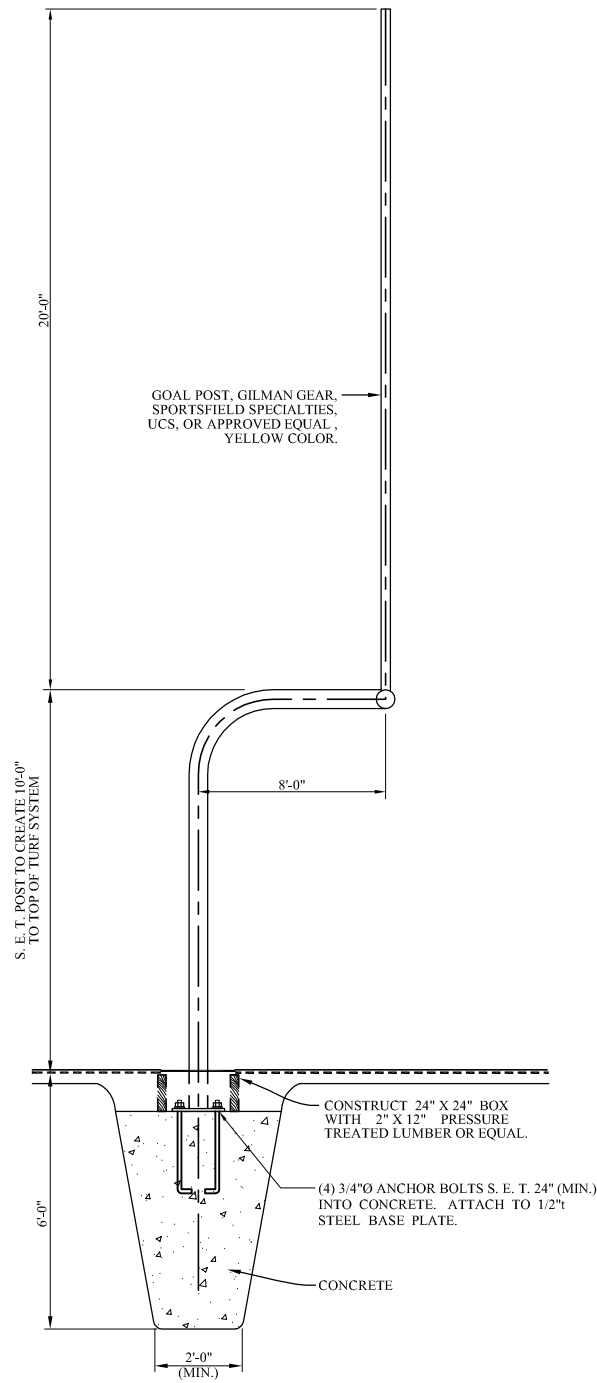

GOAL POST INSTALLATION DETAIL  
N.T.S.

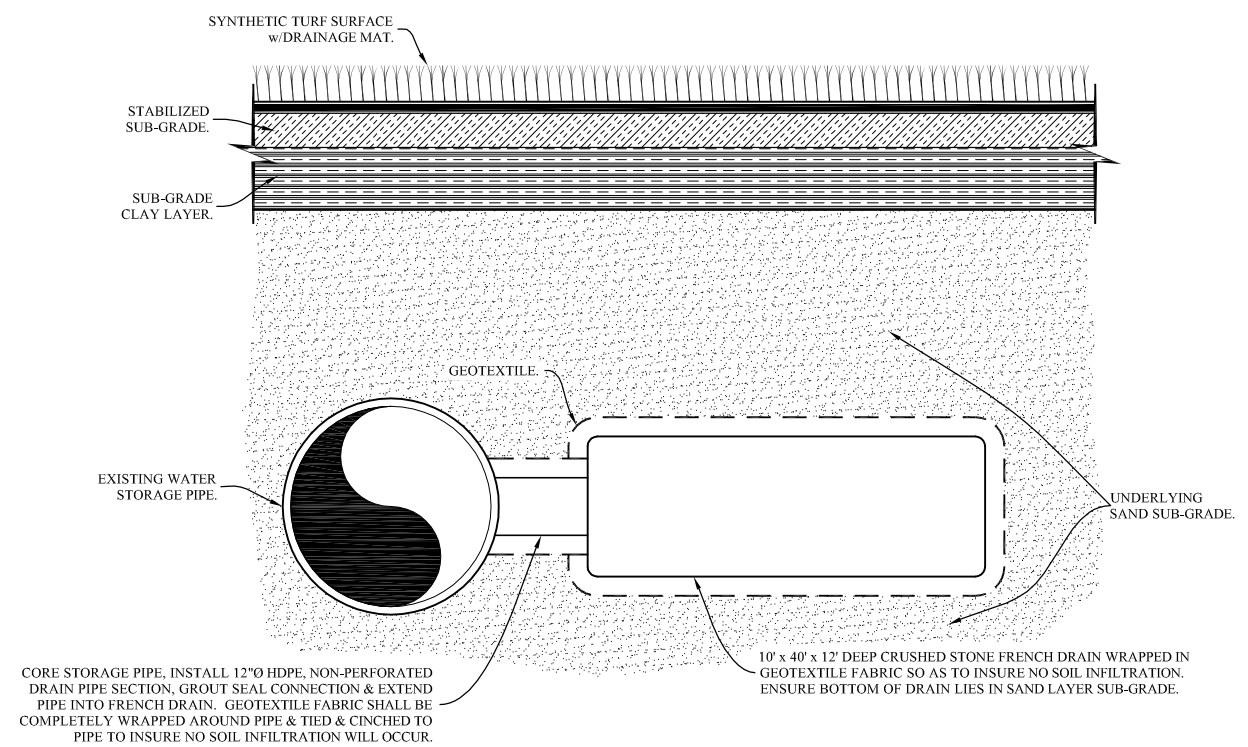

ALTERNATE PROPOSAL No. 3  
SUBTERRANEAN FRENCH DRAIN DETAIL  
N.T.S.

Jeffery J. Bresee  
04/27/10



S. E. T. SPORTS ENGINEERING TECHNOLOGIES, INC.	3D04-130 PROJECT NO. MARCH 2010 DATE
ARKANSAS STATE UNIVERSITY SYNTHETIC TURF REPLACEMENT FOR ARKANSAS STATE UNIVERSITY STADIUM	J.J.B. DESIGNED BY C.J.R. DRAWN BY XX CHECKED BY
TYPICAL DETAILS	6 of 6 REV 0